

RoHS

SPECIFICATION

- Voltage rating: 600V AC, DC
- Current Rating: 9A, AC, DC
- Withstand voltage: 1500V AC/minute
- Contact resistance: 10mΩ Max
- Insulation resistance: 1000MΩ min
- Temperature range: -40° C ~ +105° C
- Material: Base: Nylon 66 UL94V-0/2 (Natural)
- Suitable JVT1149T series TER

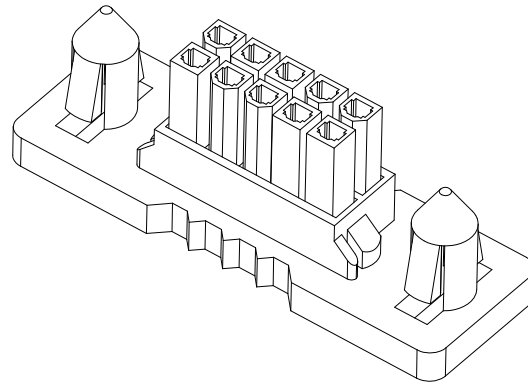

JVT4201HXX-2*XXM
 Logo
 Series NO.
 Housing
 N2-PA66 UL94V-2
 NO-PA66 UL94V-0
 Male HSG
 Single row Pin NO.

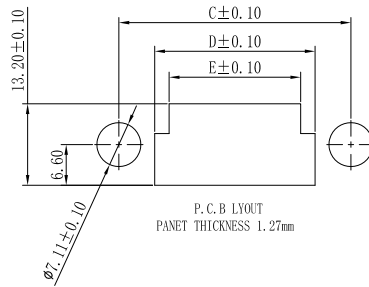
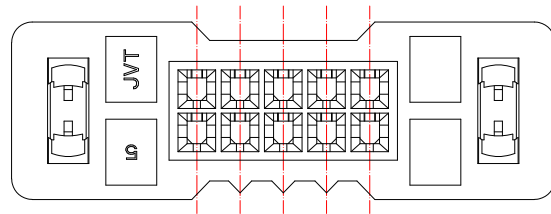
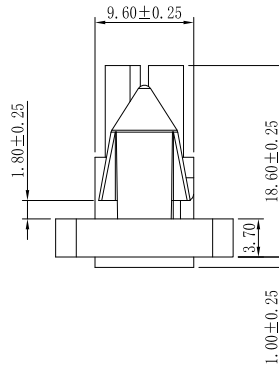
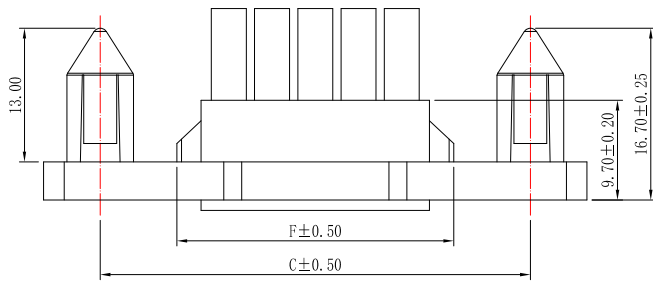
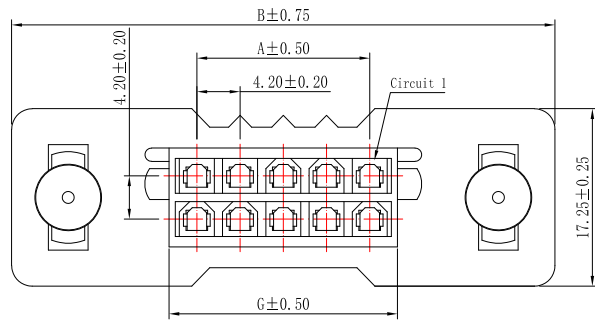

Poles	Dimension (mm)						
	A	B	C	D	E	F	G
2*01	—	36.00	25.00	13.40	8.70	10.10	5.40
2*02	4.20	40.20	29.20	17.60	12.90	14.30	9.60
2*03	8.40	44.40	33.40	21.80	17.10	18.50	13.80
2*04	12.60	48.60	37.60	26.00	21.30	22.70	18.00
2*05	16.80	52.80	41.80	30.20	25.50	26.90	22.20
2*06	21.00	57.00	46.00	34.40	29.70	31.10	26.40
2*07	25.20	61.20	50.20	38.60	33.90	35.30	30.60
2*08	29.40	65.40	54.40	42.80	38.10	39.50	34.80
2*09	33.60	69.60	58.60	47.00	42.30	43.70	39.00
2*10	37.80	73.80	62.80	51.20	46.50	47.90	43.20
2*11	42.00	78.00	67.00	55.40	50.70	52.10	47.40
2*12	46.20	82.20	71.20	59.60	54.90	56.30	51.60

Version		Tolerance correction		Date		Signature										Approved by: LI Check: CLYDE Design: LU		Standard: P/N Map title: JVT4201HXX-2*XXM		4.2mm Male HSG JVT4201HXX-2*XXM 031 Version A1	
Content of change										Unit: mm Scale: 1:1 Date: 20210323											