

RoHS

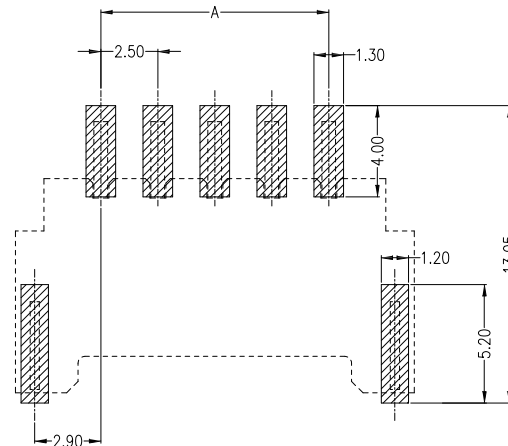

RECOMMENDED PCB LAYOUT

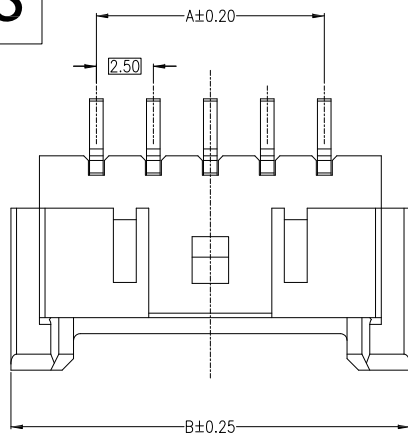
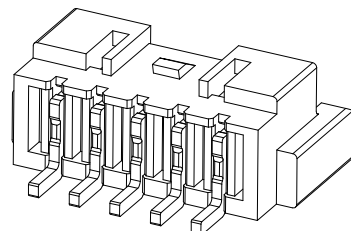
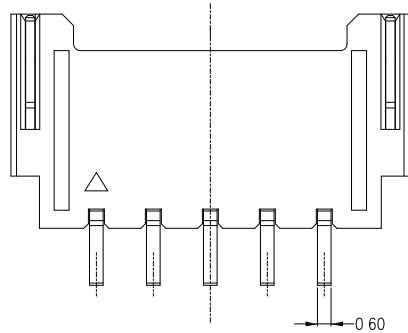
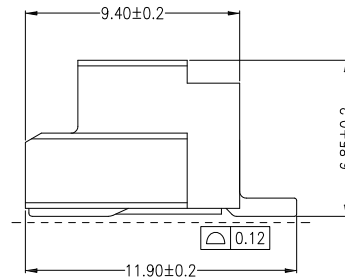
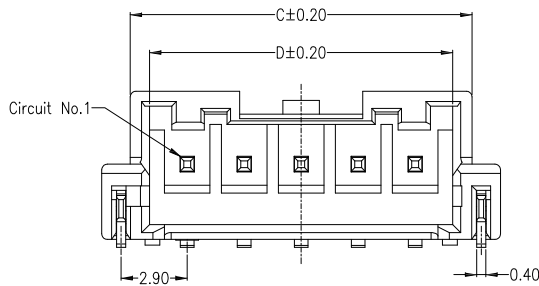

■ SPECIFICATION

- Voltage rating: 250V AC, DC
- Current Rating: 3.0A, AC, DC
- Withstand voltage: 1000V AC/minute
- Contact resistance: 20mΩ max
- Temperature range: -40° C ~ +105° C
- Insulation resistance: 1000MΩ min

■ WAFER

- Material: Base: PA9T UL94V-0
pin: Brass Tin-plated

JVT2508W9T-XXSNR-S

Logo
Series NO.
Wafer
PA9T UL94V-0

SMT
Right Angle 90°
Tin Plated
Pin NO.



Circuits	Dimensions (mm)			
	A	B	C	D
02	2.50	10.00	7.50	5.80
03	5.00	12.50	10.00	8.30
04	7.50	15.00	12.50	10.80
05	10.00	17.50	15.00	13.30
06	12.50	20.00	17.50	15.80
07	15.00	22.50	20.00	18.30
08	17.50	25.00	22.50	20.80
09	20.00	27.50	25.00	23.30
10	22.50	30.00	27.50	25.80
11	25.00	32.50	30.00	28.30
12	27.50	35.00	32.50	30.80
13	30.00	37.50	35.00	33.30
14	32.50	40.00	37.50	35.80
15	35.00	42.50	40.00	38.30

Solder Tab	2 PCS	Phosphor bronze	Sn-plated	
Contact	1~16 PCS	Brass	Sn-plated	
Housing	1 PCS	LCP	UL 94V-0, COLOR: BEIGE	
M	COMPONENT	Q' TY	MATERIAL	FINISH



Approved by	Check	Design	Standard	2.5mm WAFER 90°
LI	CLYDE	LU	P/N	JVT2508W9T-XXSNR-S
			Map title	141 Version A0

Version	Content of change	Date	Signature	Unit	mm	Scale	1:1	Date	20160507

GENERAL TOLERANCE	
0	±0.35
.0	±0.30
.00	±0.20
.000	±0.10

1

2

3

4

1

2

3

4