

RoHS

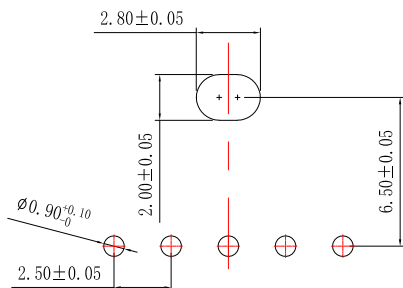
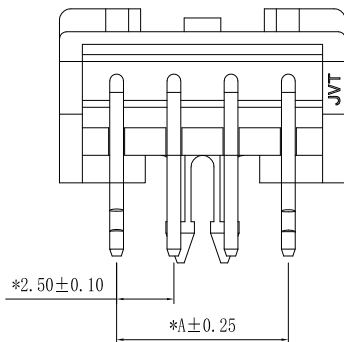
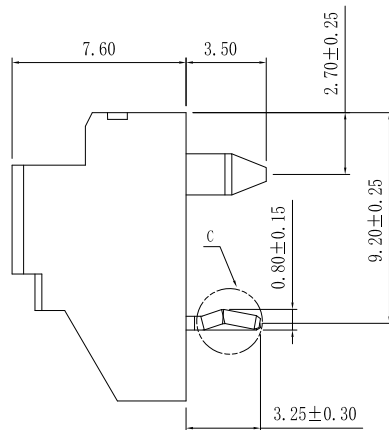
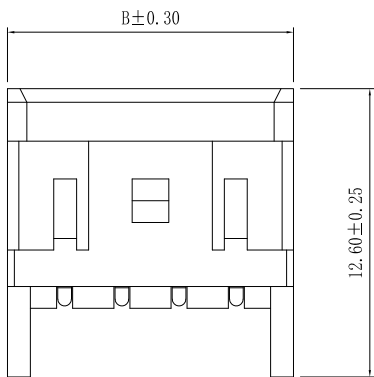
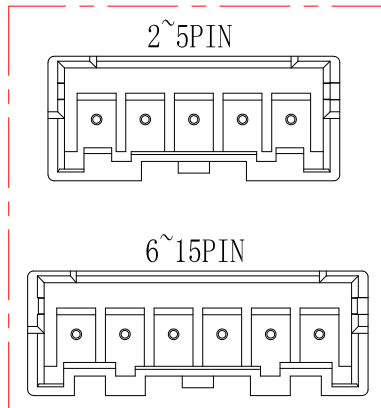
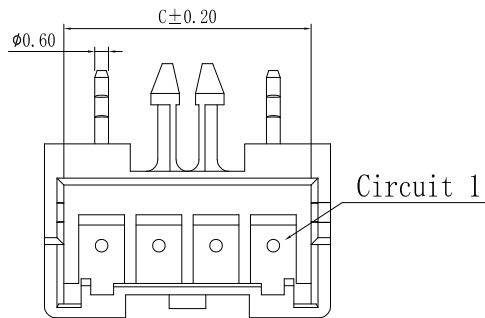

Recommend P. C. B Layout

- SPECIFICATIONS :
 - Voltage Rating: 250V AC / DC
 - Current Rating: 3A AC / DC
 - Withstanding Voltage: 1000V AC/minute
 - Temperature Range: -40℃~+105℃
 - Insulation Resistance: 1000MΩ Min.
 - Contact Resistance: 20mΩ Max.
 - Suitable JVT2508T series Terminal
 - JVT2508H series HOUSING
- Material:
 - Material: Base:PA66/PA46 UL 94V-0
 - pin: Brass Tin-plated
 - Color:Natural
- Packing specifications:
 - 02~08P 1,000 pcs/bag
 - 09~15P 500 pcs/bag

● * is the key control size

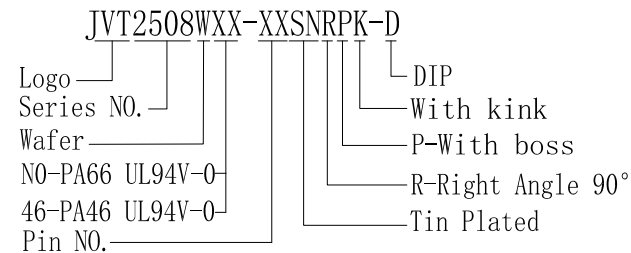

Poles	DIM			Poles	DIM		
	A	B	C		A	B	C
02	2.50	7.5	5.80	09	20.00	25.0	23.30
03	5.00	10.0	8.30	10	22.50	27.5	25.80
04	7.50	12.5	10.80	11	25.00	30.0	28.30
05	10.00	15.0	13.30	12	27.50	32.5	30.80
06	12.50	17.5	15.80	13	30.00	35.0	33.30
07	15.00	20.0	18.30	14	32.50	37.5	35.80
08	17.50	22.5	20.80	15	35.00	40.0	38.30



				GENERAL TOLERANCE			JVT 乔业连接器		Approved by		Check		Design		Standard		2.5mm 90° WAFER				
A1		增加PIN位示意图		20230517		CLYDE		JVT CONNECTORS		LI		CLYDE		LU		P/N		JVT2508WXX-XXSNRPK-D			
Version		Content of change		Date		Signature		CONNECTORS		Unit		mm		Scale		1:1		Date		20230517	
A		B		C		D		E		F		G		H							