

RoHS

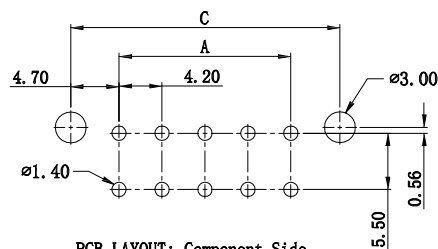
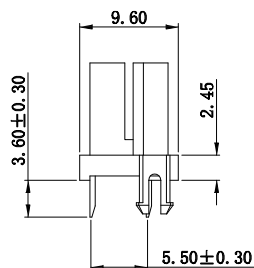
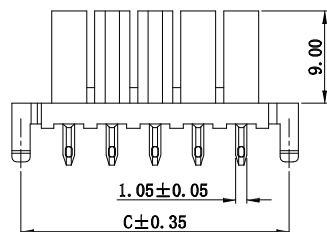
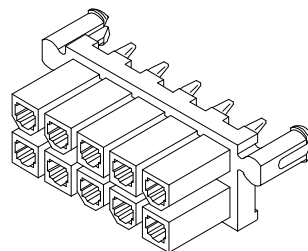
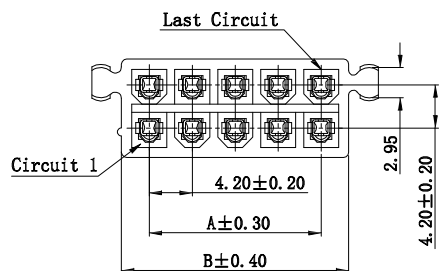

PCB LAYOUT: Component Side
Recommended PCB Thickness 1.78MAX

■ SPECIFICATION

- Voltage rating: 600V AC, DC
- Current Rating: 7A, AC, DC
- Withstand voltage: 1500V AC/minute
- Contact resistance: 20mΩ max
- Insulation resistance: 1000MΩ min
- Temperature range: -40° C ~ +105° C

■ WAFER

- Material: Base: Nylon 66 UL94V-2/0
pin: Phosphor Bronze Tin-plated

JVT1153WNO-2*XXSWP-D
 logo Series NO. Wafer PA66 UL94V-0
 DIP P-With boss SW-Matte Tin plating Pin NO.

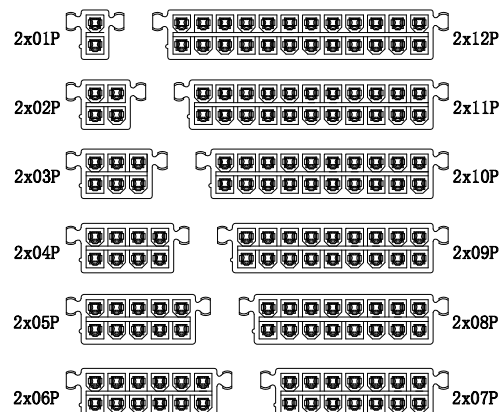

CIRCUIT SIZE LAYOUT



PART NO.	Dimensions (mm)		
	A	B	C
2x01	/	5.40	9.40
2x02	4.20	9.60	13.60
2x03	8.40	13.80	17.80
2x04	12.60	18.00	22.00
2x05	16.80	22.20	26.20
2x06	21.00	26.40	30.40
2x07	25.20	30.60	34.60
2x08	29.40	34.80	38.80
2x09	33.60	39.00	43.00
2x10	37.80	43.20	47.20
2x11	42.00	47.40	51.40
2x12	46.20	51.60	55.60

Version		Content of change		Date	Signature	JVT 乔业连接精 JVT CONNECTORS CONNECTORS			Unit	mm	Scale	1:1	Date	20210922	Approved by	LI	Check	CLYDE	Design	LU	Standard	4.2mm WAFER 180° With boss		
																					P/N	JVT1153WNO-2*XXSWP-D		
																					Map title	011	Version	A0