

RoHS

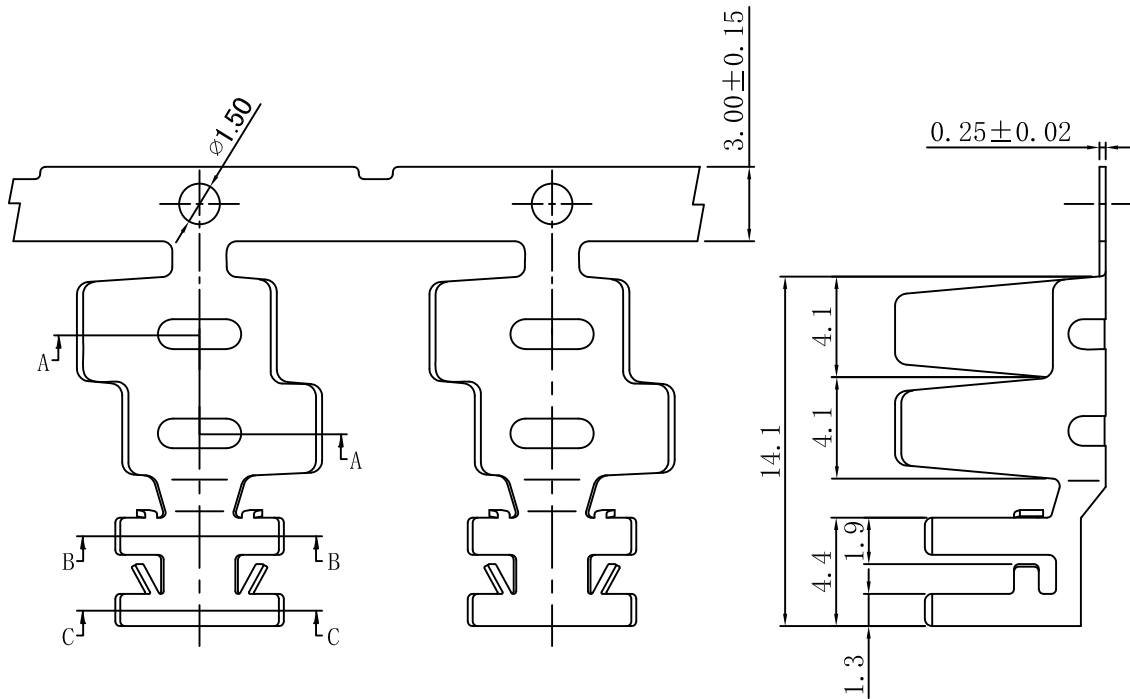

Terminal

- Material: Phosphor Bronze
- Finish: Tin-plated
- Thickness: 0.25mm
- Wire Range: 8AWG-10AWG
- O' D: 6.65mm MAX
- Applicable P.C.B. thickness 1.60mm
- Recommended PCB Hole Diameter: $\phi 4.30$ mm

JVT4316TP-SNS

Logo —
 Series NO. —
 T-Terminal —
 P-Phosphor Bronze —

S-Stamping
 before Plating
 SN-Tin Plated

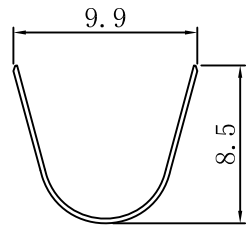

Section A-A

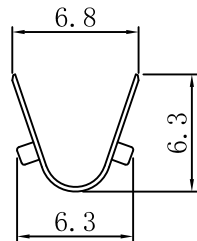

Section B-B

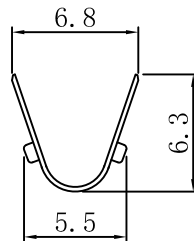

Section C-C



			GENERAL TOLERANCE			JVT 乔业连接器 JVT CONNECTORS			Approved by	Check	Design	Standard	$\phi 4.3$ 基板端子 板孔 4.30 mm 板厚 1.6 mm																
			0 ± 0.35			LI			CLYDE			LU			P/N			JVT4316TP-SNS											
			.0 ± 0.30			Unit			mm			Scale			1:1			Date			20220609								
Version			Content of change			Date			Signature			Unit			mm			Scale			1:1			Date			20220609		
			.00 ± 0.20			Date			Signature			Unit			mm			Scale			1:1			Date			20220609		
			.000 ± 0.10			Date			Signature			Unit			mm			Scale			1:1			Date			20220609		

A

B

C

D

E

F

G

H