



**Dongguan GongFu Electronics Co.Ltd. GFEFUSE® Focus: fuse holder and fuse**

---

## **1H20L Series DC(EV) fuse**

### **1. Purpose and use**

This series of fuses are suitable for lines with rated DC voltage below 250V (125V), rated current of 70A-300A and breaking capacity of 20kA. They are widely used in semiconductor protection, mobile forklift, electric elevator, charger, power supply, on-board battery, on-board circuit system and inverter integrated protection. At the same time, it has the characteristics of strong current limiting capacity, large breaking capacity and fast short-circuit breaking speed. Can withstand temperature shock, mechanical shock, current shock, chemical load, etc. Performance refers to JASOD622, and environmental reliability conforms to ISO8820, JASOD622 and GB / T31465

### **2. Normal working conditions**

Normal operating conditions of ambient air temperature: - 5 °C ~ 40 °C; allowable operating conditions: - 40 °C ~ + 125 °C;

### **3. Use category**

**Full range fast fuse(gR)(aR)**

### **4. Structural characteristics**

The melting tube of the product is made of high-temperature resistant ceramic material, with high flame-retardant performance and strong hardness.

---

**TEL:0769-82391938**

**FAX:0769-82391939**

**<http://www.dcfuselink.com>**



## Dongguan GongFu Electronics Co.Ltd. **GFEFUSE®** Focus: fuse holder and fuse

The melt is sealed in the melting tube with a variable cross-section melt made of 99.99% pure silver. The melting tube is filled with chemically treated high-purity quartz sand and specially treated chemical materials as arc extinguishing medium. The contact surface is silver plated to ensure reliable electrical performance, greatly reducing temperature rise and power consumption; Both ends of the melt are firmly connected with the contact by spot welding, which greatly enhances the safety and reliability of breaking short circuit fault current

### 5. Agreed current and agreed time

Test current A	Fusing time s	
	In: $\geq 60A$	
	min	max
1.1In	14400	-
1.35In	150	3600
1.5In	20	1500
2In	1	300
3In	0.2	30
5In	0.05	1

**Note: the agreed current and agreed time required by the customer can be negotiated with our company.**

**The characteristics of fuse will vary according to the use environment and surrounding design requirements.**

**TEL:0769-82391938**

**FAX:0769-82391939**

**<http://www.dcfuselink.com>**



Dongguan GongFu Electronics Co.Ltd. **GFEFUSE®** Focus: fuse holder and fuse

**The performance characteristics are obtained according to the rated constant temperature of 25 °C**

## 6. Main parameters

NO:	Product model	Rated current (A)	Rated voltage	Maximum voltage drop 110%(mV)	Breaking Capacity (KA)
			DC (V)		
1	1H20L070	70	125V/150V	100	20
2	1H20L080	80	125V/150V	90	20
3	1H20L100	100	125V/150V	96	20
4	1H20L125	125	125V/150V	86	20
5	1H20L150	150	125V/150V	96	20
6	1H20L200	200	125V/150V	87	20
7	1H20L250	250	125V/150V	84	20
8	1H20L300	300	125V/150V	85	20

## 7. Product scale:

TEL:0769-82391938

FAX:0769-82391939

<http://www.dcfuselink.com>

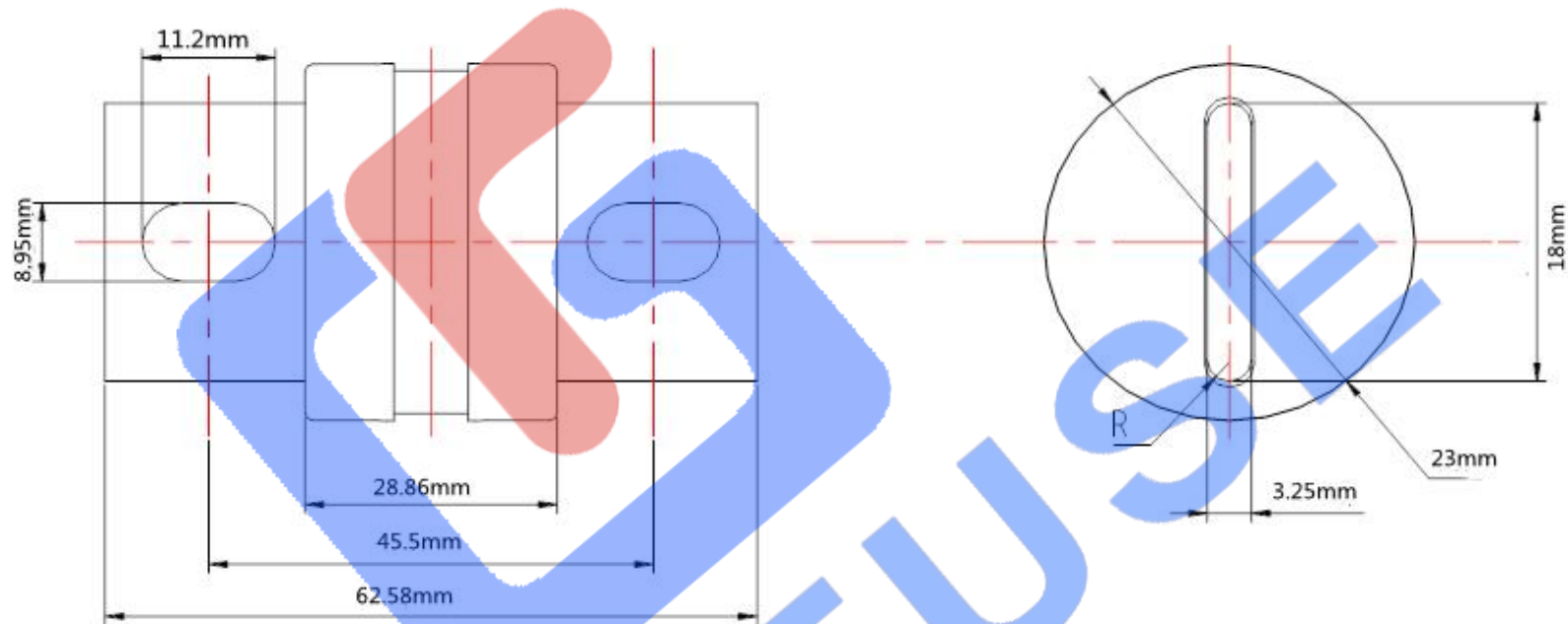

**8. Characteristic curve:**



Dongguan GongFu Electronics Co.Ltd. **GFEFUSE®** Focus: fuse holder and fuse

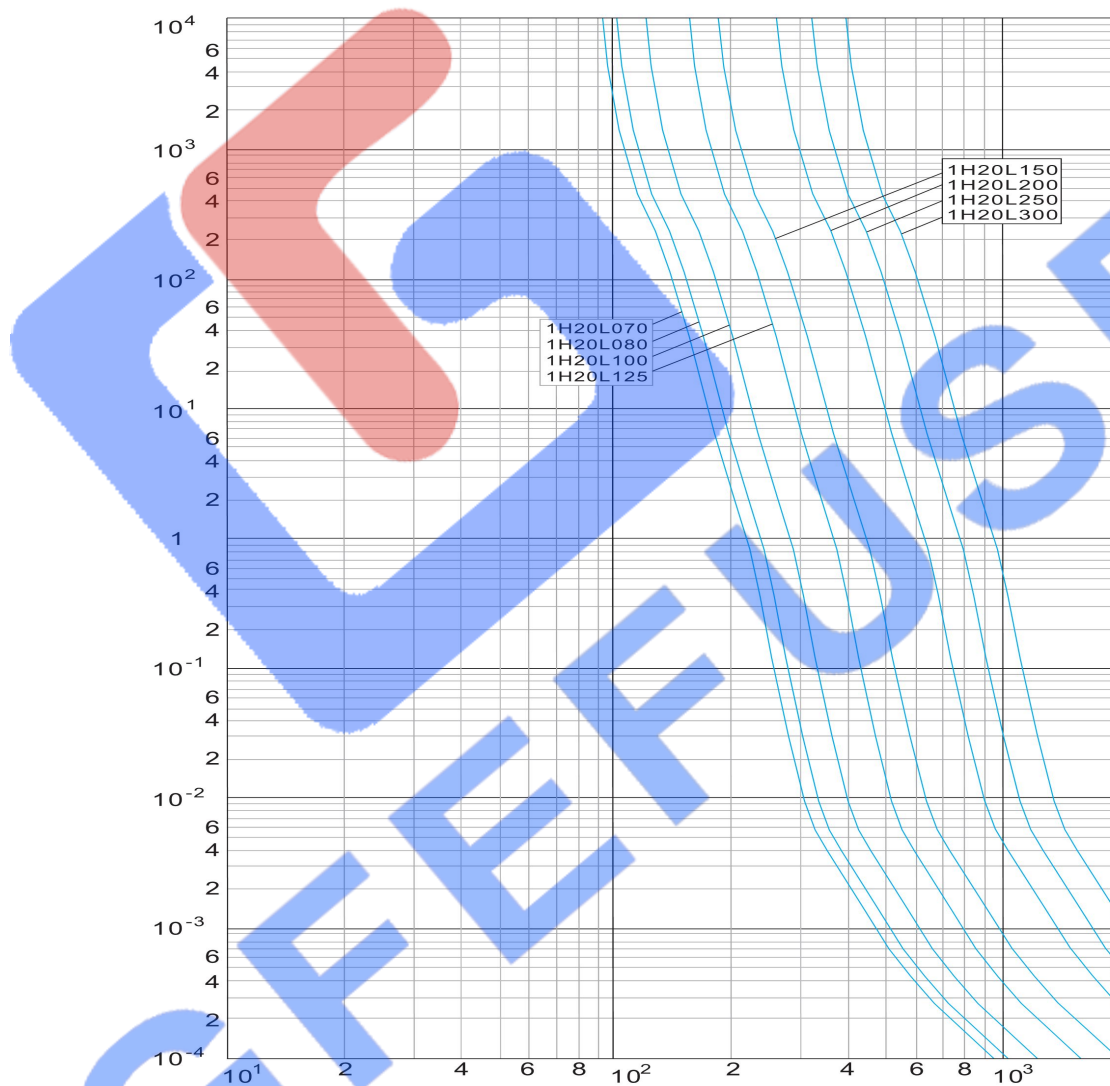

TEL:0769-82391938

FAX:0769-82391939

<http://www.dcfuselink.com>